

F:\PROJ\SD\BC\OLD JUPITER ELEMENTARY\00-SITE PLANS\JES-SITE EXP.dwg, SP1, 8/30/2007 8:00:36 AM, Letter, JAH

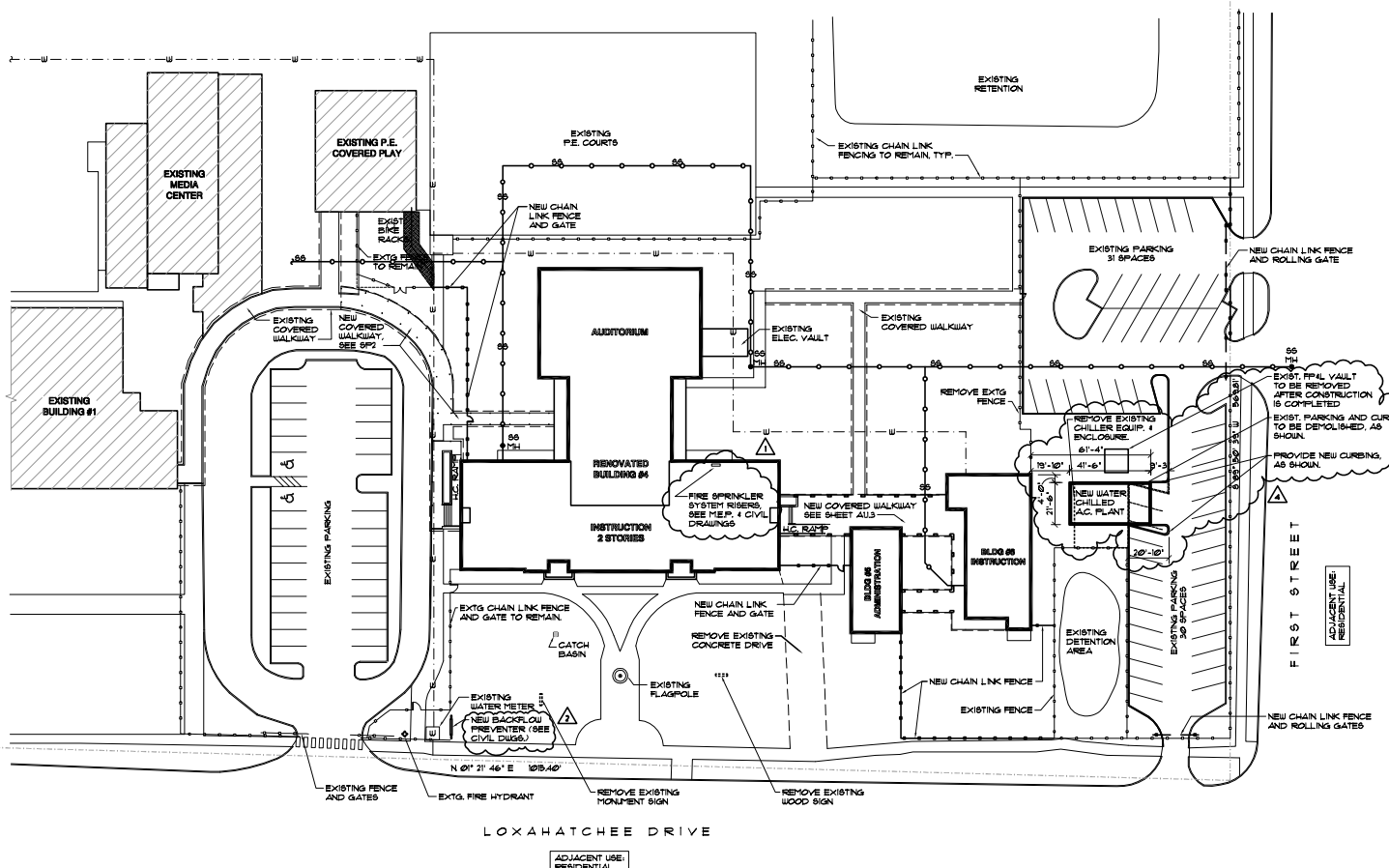

**PARTIAL PROPOSED SITE PLAN**  
SCALE: 1" = 30'-0"

SITE DATA	
NAME OF PROJECT:	JUPITER ELEMENTARY SCHOOL RESTORATION & REMODELING
MUNICIPALITY:	TOWN OF JUPITER
PROPOSED USE:	ELEMENTARY EDUCATION (NO CHANGE)
BUILDING HEIGHT:	NO CHANGE
BUILDING AREA:	NO CHANGE
PARKING:	NO CHANGE
(WIND VELOCITY ZONE) 140 MPH (APPLIED TO DESIGN OF NEW STRUCTURAL ELEMENTS)	
LOCATION MAP	
GENERAL LEGEND	
	EXISTING WATER METER
	EXISTING WATER LINE
	EXISTING MANHOLE
	EXISTING SANITARY SEWER LINE
	FENCE AND/OR GATE
NOTES	
<ol style="list-style-type: none"> <li>SEE BUILDING DEMOLITION AND PROPOSED PLANS FOR MORE DETAILED DESCRIPTION OF WORK SCOPE.</li> <li>SEE LANDSCAPE PLANS FOR NEW PLANT MATERIAL AND IRRIGATION SYSTEMS.</li> <li>NORTH PARKING AREAS TO BE USED TEMPORARILY FOR CONSTRUCTION TRAILERS, STAGING, AND ACCESS. CH1 TO ADJUT PROPOSED LAYOUT TO ARCHITECT OF TEMPORARY BARRICADES.</li> <li>SEE MEP DRAWINGS FOR CONDUIT AND PIPING ROUTES PROPOSED TO EXISTING SITE SERVICES. CONTRACTOR TO COORDINATE WITH EXISTING UNDERGROUND UTILITIES AND NOTIFY ARCHITECT OF ANY DISCREPANCIES OR OBSTACLES TO NEW INFRASTRUCTURE.</li> </ol>	

DOW-HOWELL-GILMORE-ASSOCIATES, INC. ARCHITECTS & ENGINEERS 2400 S. W. 10TH AVENUE, SUITE 100 MIAMI, FLORIDA 33135 PHONE: (305) 441-1111 FAX: (305) 441-1112	RENOVATION OF BUILDINGS 4, 5, & 6 <b>JUPITER ELEMENTARY SCHOOL</b> 200 S. LOXAHATCHEE DRIVE JUPITER, FLORIDA 33458	PROPOSED SITE PLAN SP1
--	--	---------------------------